

PRODUCT DATA SHEET

siFRAMO Beam Clamp

Application

Pre-assembled component to clamp beam section F100 to the flange side of traditional steel sections.

Product Information

26067

- Holder with thread M10 plate
- 2 hexagon nuts M10
- 2 washers

26068 & 26069

- Holder with thread M12 Plate
- 2 beam clips
- 2 hexagon nuts M12

Installation

- U-Holder to be used in pairs.
- 26067 - up to flange thickness 16 mm
- 26068/26069 - up to flange thickness 40 mm

Technical Data

Material: Steel, FK 8.8, HCP



NEPD-4539-3797-EN

Code	Thread	Tightening Torque [Nm]	Fz per U-Holder [kN]	Fy [kN]	My [kNm]	Mz [kNm]
26067	M10	40	9.5	*	*	*
26068	M12	85	16	*	*	*
26069	M12	85	16	*	*	*

* Please contact us for these figures

Code	Weight (KG)	Pack Qty
26067	0.7	20
26068	1.6	10
26069	1.7	10

For further product information, please contact one of the Kernow team on 01726 624600 or sales@kernow-how.com

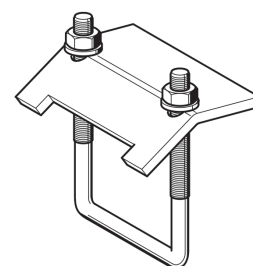

26067

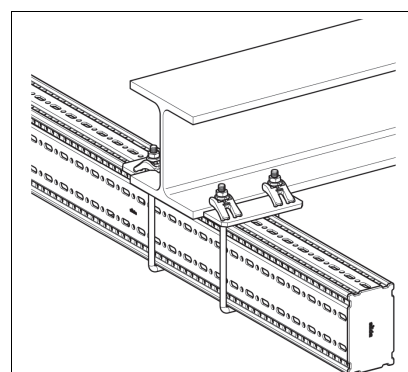
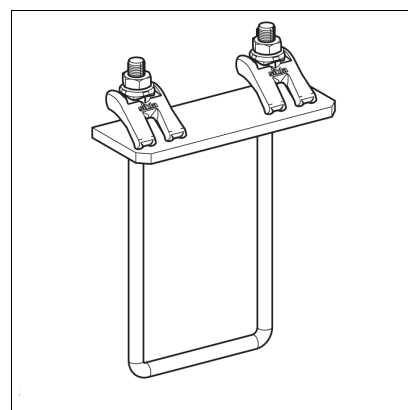
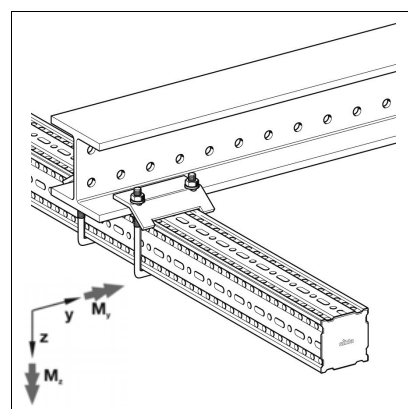

26068 & 26069